



Oil Premium Illustrations

mill®



1. DESCRIPTION OF THE HEATER

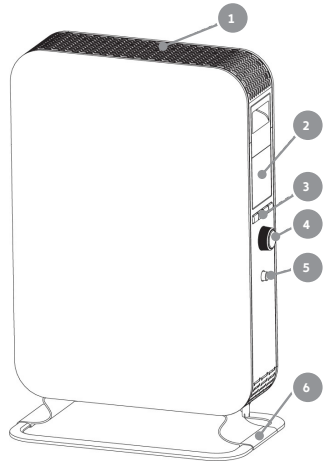

2. PARTS

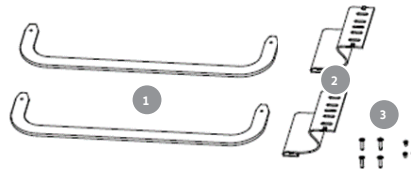

3. ASSEMBLY

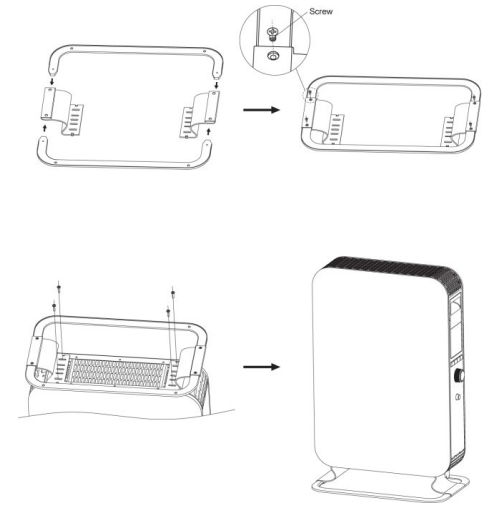

4. INSTRUCTIONS DAY/NIGHT THERMOSTAT

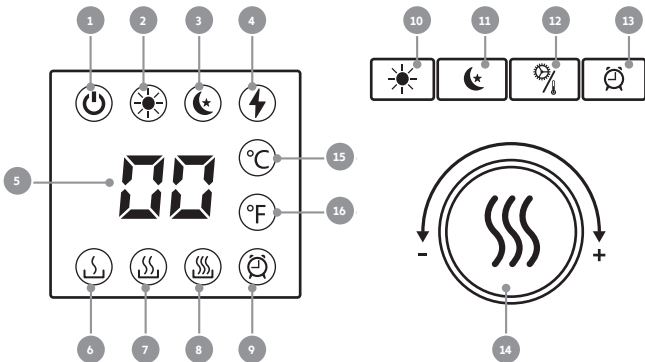

5. USAGE DAY/NIGHT THERMOSTAT

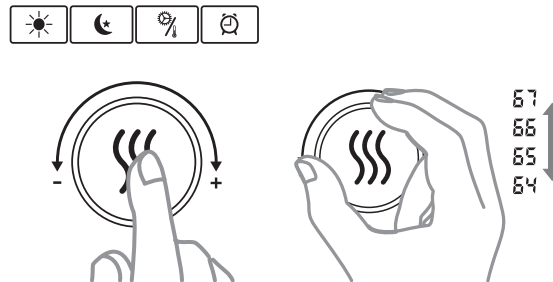

6. TIMER FUNCTION

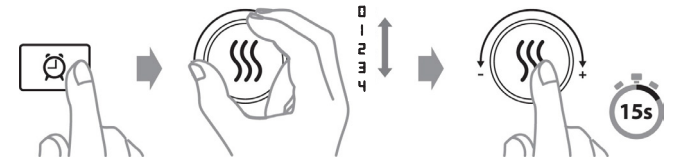



7. HOW TO ACTIVATE DAYTIME SETBACK

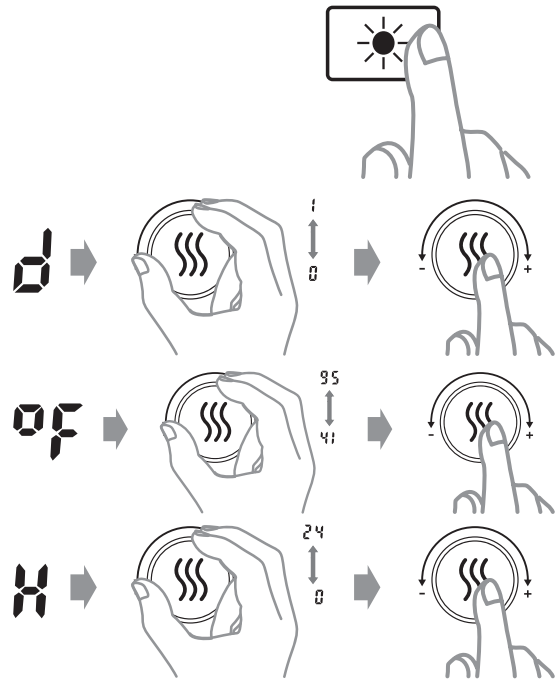

13. CANCEL (SKIP) SETBACK PERIOD

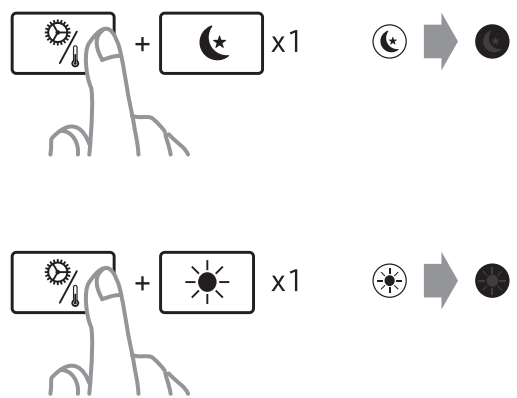

8. HOW TO ACTIVATE NIGHTTIME SETBACK

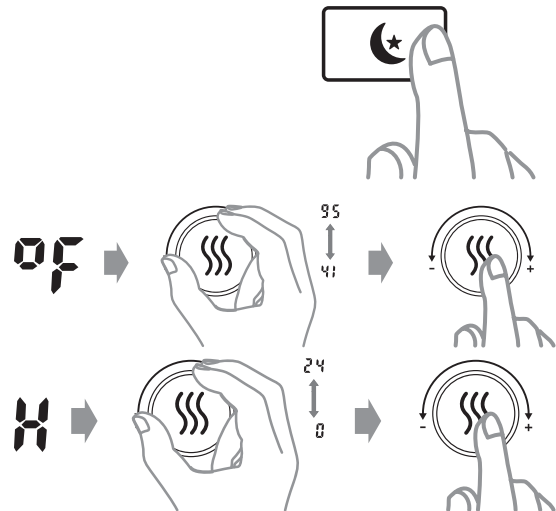

14. DELETE A SETBACK PROGRAM

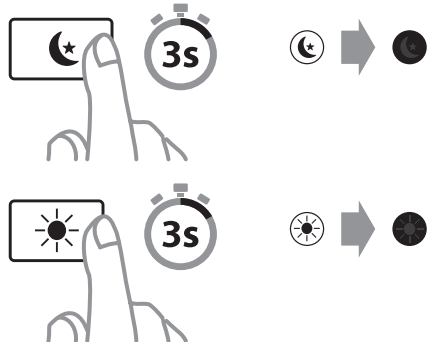

16. RESETTING THE HEATER

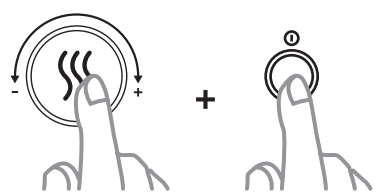

9. CHANGE SETBACK TEMPERATURE – DAYTIME



10. CHANGE SETBACK TEMPERATURE – NIGHTTIME



11. CHANGE NUMBER OF HOURS – DAYTIME



12. CHANGE NUMBER OF HOURS – NIGHTTIME



15. TEMPERATURE CALIBRATION

